

Missouri State Beekeepers Association

P.O. Box 448 Oak Grove, MO 64075

www.mostatebeekeepers.org

February 2009

Eugene Makovec
Editor

Missouri and Kansas beekeepers to hold joint Spring Meeting

March 6-7 in Overland Park, Kansas

The last time the Missouri State Beekeepers Association joined forces with the Kansas Honey Producers Association, over 270 attendees filled the host hotel's rooms and meeting facilities to enjoy two full days of lectures and activities. Leaders of both groups pronounced that March 2006 meeting a rousing success and vowed to do it again sometime.

That time has come. Join us on Friday and Saturday, March 6-7, 2009, as a variety of entomologists, research scientists and other experts lecture on honeybee biology, disease prevention and beekeeping methods. We'll also have a number of breakout workshops on topics ranging from soap and lotion making to agritourism.

We are again meeting at the:

Overland Park Marriott

10800 Metcalf (I-435 & Exit 169 Highway-Metcalf)

800-228-9290 or 913-451-8000

Make reservations by February 12 to get our group rate of \$85.00 plus tax. (Reference group code **American Beekeepers**.)

Our guest speakers include:

Dr. Clarence Collison, professor of Entomology and head of the Department of Entomology and Plant Pathology at Mississippi State University. Prior to moving to Mississippi he was an extension entomologist at The Pennsylvania State University, where he served as a beekeeping/pollination specialist. He began writing his monthly column "Do You Know?" for Bee Culture magazine in 1984.



Dr. Clarence Collison

See "Spring Meeting" on page 9

Here comes the sun ...

The days are getting longer, and your bees have already begun their Spring preparations. Queens are laying and, on warm days, workers can be seen carrying in pollen. You can help with a few early-season chores. If it's honey production you want, see page 4 for tips on what you can do in February to achieve a strong field force in June.



INSIDE THIS ISSUE:

<i>From the president</i>	2	<i>Website update</i>	6
<i>Scott Moser</i>		<i>Spring Meeting registration</i>	7
<i>Cookin' with honey!</i>	3	<i>Spring Meeting program</i>	8-9
<i>Honey oatmeal cookies</i>		<i>Local club information</i>	11
<i>Early Spring management</i>	4	<i>Membership application</i>	12
<i>Meeting vendor list</i>	5	<i>Honey Queen report</i>	13
<i>Pick up your order at the meeting!</i>		<i>Directory of officers</i>	13
<i>Eastern beginners workshop</i>	6		



From the President

by Scott Moser

As I sit here typing this, the temperature outside is a balmy 15 degrees, and the wind is howling. I can't help but wonder about how my bees are faring in this kind of weather. Over thousands of years, Mother Nature has given them the skill to survive such weather, and in actuality, this brutal cold is probably more of a problem for the beekeeper than for the bees. While sitting nice and warm in front of the woodstove with my dogs, I began to tick off a mental list of things I wanted to accomplish in the upcoming New Year. Some of those things were beekeeping related, while some of them were not. It seems like each of us begins to make resolutions this time of the year, so it seemed only logical that I make up a "to-do list" for the year.

One of the things that I would like to do is to let the MSBA membership know a little bit about me. Many of you have seen me at the meetings, but as is often the case, it is hard to take the time to stop and talk beekeeping or just visit with so much going on in such a short time. I have been keeping bees for about 11 years now, and like many of you, I began with just a couple hives in the backyard. By the end of the first season, those two hives had become eight, and 11 years later, that number has swelled to almost 100 colonies spread all over Jefferson and Franklin counties. Since I often feel that beekeeping is a full-time job, I guess you could say that my part time job is teaching 7th grade science. In between the bees and teaching, I like to spend time in the outdoors. Due to my varied interests, I am comfortable talking hunting, fishing, honeybees, or even the mysterious world of the modern 7th grader.

Another one of the items on my "to-do" list is to focus on one of the main goals of the MSBA, and that is education of others, be it the public or beekeepers. It is important that we share our wealth of knowledge with others. Throughout my 11 years, I have relied on many different beekeepers for suggestions and advice. I want to take a moment to thank Jim Buxton, Ted Jansen, Ray Batton and Ray Nabors for all the advice, information, suggestions, help and support that they have given me throughout this journey. Without them, I don't think I would be where I am today. It is important for us to help other beekeepers whenever possible, so that we have more successes and fewer failures. In addition, we each need to pass on what we know so that when we are gone our knowledge is not lost. Before their passing, beekeepers like Howard Hileman and Walter Smith were a wealth of information for many beekeepers, but unfortunately much of that information went with them. They knew that educating newcomers was important to bringing in and keeping new beekeepers. I still miss them, and always will because of what I learned from them.

Local associations have always been the backbone of beekeeping and the MSBA. At the Fall Meeting, I looked at the map of local associations, and one thing I noted, like several other people did, was the lack of local associations north of the Missouri River. It struck me that here was some of the state's prime beekeeping habitat, and there were a large number of beekeepers who were not being served by local associations. One of my goals during my upcoming two years in office is to start at least two new locals north of the river. In addition, I challenge any other local to "pay it forward" and

help start at least one local association on their own. It isn't that difficult to do, because the Jefferson County Beekeepers, with the help of Mary Reed, helped get the Parkland Beekeepers started, and they have a large and hard-working membership in the Farmington area. There is no reason that every county in the state could not support a local association. I am aware that many established local associations fear that a neighboring local may drain membership from them, but I have found the opposite to be true, and in fact, membership often goes up in both the established and the new local. How many of you are members of two or more local associations?

Finally, I would like to see more local associations represented at the MSBA executive meetings and the general membership meetings. The MSBA does some really wonderful things that beekeepers should take advantage of. How often has your local association brought in guest speakers like Jim Tew, Marion Ellis, Marla Spivak, Dianna Sammataro and Dewey Caron, to name a few. The MSBA meetings offer the beekeeper the opportunity to meet and talk with some of the best known beekeepers in the state and from around the country. In an effort to spread the word more, I am going to try and make it to as many local meetings as I can in the next couple of years. If I can't make it, I would like to call on my directors to touch base with the locals in their area in an effort to let beekeepers know what we do.

In closing, I want to thank all of you for your support of me and the MSBA. A few years ago, I was a bit apprehensive about running for Secretary of the MSBA, and even more apprehensive about becoming the Vice President, knowing that I was thus destined to become President in two years. One of the things that helped ease my mind was the fact that I knew I was going to be giving back to the beekeeping community in a meaningful and satisfying way. It was time for me to "pay forward" for what I had learned and the friends that I had made. I want to thank Ken Norman and Ron Vivian for encouraging me and helping me out when needed. It is my goal to build on the foundation of previous presidents, and to make the MSBA an even better association that can help any beekeeper, be it the hobbyist or the large scale producer. I am looking forward to serving all of you as President. Now, it is time to throw another log into the stove, and get back to that "to-do" list. Hmmm... I think I will move "more fishing time" to the top of that list! Happy New Year to you and yours!

Scott

THE HAWLEY HONEY COMPANY

220 North Elm Iola, KS 66749

620-365-5956 (After 8 pm 620-365-7919)

White clover honey strained in 5-gallon buckets.

We will pack it in your jars for an extra fee.

Bee Equipment - New and Used - Used Extractors

Corn syrup, sugar syrup and SUGAR

Bees -- Frames of brood

Call for prices.

Can deliver to Kansas City, Joplin or Butler, MO



Cookin' with honey!

by Carrie Sayers

Honey Oatmeal Cookies

-- from *The Pooh Cookbook*, by Virginia Ellison

Yield 2-1/2 to 3 dozen cookies

Prep time including baking: One-ish hours

Ingredients

2 T Butter (room temperature)

1 T Vegetable Oil

½ C Brown Sugar

¼ C Honey

1 Egg

1 T Water

½ C All Purpose Flour (sifted)

½ t Salt

¼ t Baking Soda

1-1/2 C Rolled Oats

½ to ¾ C of the following:

Your choice goodies to add: Chopped dates, figs, apples, raisins, craisins, chocolate chips, chopped nuts -- or mix them up!

Method

Pre-heat oven to 350 degrees.

Use Silpat, parchment paper or butter baking sheets.

Blend the butter, oil, brown sugar, honey, egg and water thoroughly.

Sift the flour, salt and baking soda together, then add the rolled oats.

Stir and blend the oats mixture with the liquid mixture.

Finally, mix in whatever goodies you chose.

Drop heaping teaspoonfuls onto the baking sheets.

Bake for 12-15 minutes.

Let sit 5 minutes on sheet, then remove with spatula to wire rack to cool.

Enjoy!

Carrie Sayers (www.sayerscatering.com) is a first-year beekeeper and a member of the Missouri State Beekeepers Association and the Eastern Missouri Beekeepers Association. She lives in Glendale, MO, and has been cooking with honey for years.



WALTER T. KELLEY CO.

1-800-233-2899

www.kelleybees.com



"Package Bees"

3 lb. Swarm with Italian Queen.....\$72.00

3 lb. Swarm with Russian Hybrid.....\$75.00

Pick up or ship on Saturdays March 28th / May 9th



"A Complete line of beekeeping supplies"

Whether your a "newbee" or a seasoned pro, Kelley's has you covered! We are a full line manufacturer with 85 years of experience.

- Protective clothing
- Woodenware
- Wax foundations
- Extracting & Bottling
- Tools
- Motors, Pumps & sumps
- Accessories & more

Our 85th
Year!





Early Spring management

by Eugene Makovec

Get a jump on the beekeeping pre-season, and your bees will jump on the honey flow

The following is based on a method taught by Ted Jansen over the past several years, and is designed to bring your colony's field populations to a peak just in time for the main honey flow. The dates used are based on an average season in St. Louis County.

Mid-February: Reduce your two-story hive to one story. This should be done on a warm, sunny day (55+ degrees), as soon after February 15 as possible.

Begin by setting both boxes to one side on an inverted outer cover. Clean debris from the bottom board, and set one empty hive box on it. Take the frames containing the broodnest from the overwintered colony and place them in the center of the empty box. Place two frames of empty, drawn comb on each side of the brood nest. Next, place one frame of pollen on each side. Finally, fill out the rest of the box with honey frames.

This process has two benefits. First, this early Spring manipulation stimulates brood production. Secondly, it provides a perfect opportunity for you to cull old and damaged comb from your hive.

Here's one of Ted's handy tips: If you have enough good frames with you, place the second box (with empty comb and/or foundation) back on top, with the inner cover in between. The bees will not move up through the inner cover, and your upper story will be in place for the next step.

Two to four weeks later (depending on weather): When you pop the lid and most of the frames are covered with bees, it's time to add the second story (or pull out the inner cover dividing the two stories). This gives the bees a full story for upward expansion, thus discouraging the swarm impulse.

Mid-April: About six weeks before the peak of the main honey flow, equalize your colonies so that each hive has about four full frames of bees and brood, adequate stores, and a healthy queen.

Move bees/brood from overpopulated hives to lighter hives to reduce the probability of the strong colonies swarming. If your strong hives outnumber the weak, the same thing can be accomplished by making splits.

There are two methods of splitting a colony. (Okay, if you've attended a few beekeeping meetings, you know that there are hundreds of methods, but we're dealing in generalizations here.) One is to take excess bees and brood from one or more strong colonies and introduce a queen or swarm cell to them.

If you do not have a source for queens in April, or prefer to raise your own, then place those same excess bees and all stages of brood (including eggs) in an empty hive or nucleus box with a frame of pollen and at least one of honey, and let them do their thing. Your goal here is a colony for next year, but this is nature at its finest!

7c's Winery

www.7cswinery.com
vintner@7cswinery.com
417-988-9829
Walnut Grove MO



**We Want to Buy
Varietal Honey
4-5 Buckets Per Variety
For Delivery
Fall 2008 / Spring 2009**

FOR SALE

FUNCTIONING APIARY

Prefer to sell as a unit but will divide.

Honey operation including 40x40 Morton building, retail store with apartment and second floor office, customer website, bottling system and equipment, bee equipment, extracting equipment, creamed honey equipment.

For more company information, visit
www.logchain.com.

For more information, contact:

Ann Garber

logchain@grm.net

Log Chain Honey

Box 36 Allerton, Iowa 50008

641-873-4119



Heartland Honey and Beekeeping Supplies

19201 South Clare Road
Spring Hill, KS 66061
913-856-8356
www.heartlandhoney.com

HONEY AND WAX FOR SALE

3 cases Ross Round comb honey (54 count)
1 case Basswood section honey (36 count)
Light amber honey in 5-gallon pails
Light wax in 15-pound blocks
Andrew Honey Farm 217-938-4975
Near Hamilton, IL -- or can deliver at the
Spring Meeting in Overland Park

WEAVER'S FAMOUS QUEENS

And Package Bees

Buckfast & All-American
OVER 121 YEARS OF SERVICE
THE R WEAVER APIARIES, INC.
16495 C.R. 319, NAVASOTA, TX 77868
Phone (936) 825-2333 FAX (936) 825-3642
EMAIL: rweaver@rweaver.com
WEBSITE: www.rweaver.com

FOR SALE:

PACKAGE BEES

For pickup in Lynnville, IA or Hamilton, IL.
2# and 3# packages from C.F. Koehnen
and Sons. Your choice of Carniolan or
Italian queens. Delivery in early April.
Contact Phil Ebert 641-527-2639 or e-mail
ehoney37@netins.net

Support our meeting vendors and advertisers

As of press time, the following vendors had confirmed plans to attend the meeting. You can save on shipping costs by placing orders with these vendors ahead of time to be picked up during the meeting.

Walk-About Acres (Vera and Art Gelder)
All beekeeping supplies 573-474-8837
walkaboutacres@agristar.net

Femme Osage Apiary (Ian and Pam Brown)
Handcrafted woodenware and other supplies 636-398-5014
femmeosage1@aol.com

Draper's Super Bee* (Larry and Brenda Draper)
All beekeeping supplies 402-274-3725

Hawley Honey Company*
Honey, corn syrup and beekeeping supplies 620-365-5956

Dadant and Sons*
All beekeeping supplies 888-922-1293 www.dadant.com

Heartland Honey and Beekeeping* (Joli Winer and Cecil Sweeney)
Candlemaking and beekeeping supplies 913-856-8356
www.heartlandhoney.com

Andrew Honey Farm*
Honey (comb and liquid) and wax 217-938-4975
magic@adams.net

*See ad in this issue

Bee Culture

THE MAGAZINE OF AMERICAN BEEKEEPING

Here's what you'll get

- Honey bees • Beekeeping • Beekeepers •
- Honey • Propolis • Bee Equipment •
- Beeswax • Current Research •
- Beginning Beekeeping How-To •
- Sideline Beekeeping • New Products •
- Honey Recipes • Book Reviews •
- Market Reports • More • More • More • More!

Skip the secretary • Call Today
Tell Us What Club You're In -
Get The Discount

GET YOUR
BEE CLUB DISCOUNT
\$21/1 year
\$38/2 years

Send check to:

Bee Culture Magazine
623 W. Liberty St., Medina, OH 44256
or call 800-289-7668, Ext. 3220
with credit card



Eastern MO Beekeepers to host 2nd annual beekeeping workshop

Leading educators to present courses for beginners and experienced beekeepers

The Eastern Missouri Beekeepers Association will offer full-day courses of instruction for beginning and experienced beekeepers on Saturday, February 21, 2009, from 8:00 a.m. to 5:00 p.m. at Maritz in Fenton, Missouri.

The courses will be led by two nationally recognized beekeeping educators: Dewey M. Caron, PhD., Professor of Entomology and Wildlife Ecology, University of Delaware, and Visiting Scientist at Oregon State University, and Phil Craft, Kentucky State Apiarist.

Dr. Caron is the author of numerous papers and teaching publications, including Honey Bee Biology and Beekeeping. In addition to his teaching and research, he founded and chaired the Mid-Atlantic Apicultural Research and Extension Cooperative (MAAREC), the country's leading university beekeeping cooperative research and teaching facility, and is active in beekeeping development abroad. Dr. Caron is the 2001 recipient of the Eastern Apicultural Society Roger A. Morse Outstanding Teaching Award.

Mr. Craft, a graduate of Oberlin College, is a past president of the Apiary Inspectors of America, has served as Program Chairman for the Eastern Apicultural Society, and is currently the Chairman of the Heartland Apicultural Society. Mr. Craft has extensive experience as a director and faculty member at national and regional beekeeping schools and meetings, and is much in demand as a speaker for beekeeping organizations.

The Beginner's Class is specially designed to provide everything necessary for beginners to learn how to keep bees and make honey in 2009. The Experienced Class is intended for beekeepers who have kept bees for at least a season, and wish to continue or expand their beekeeping. The courses will be followed throughout the beekeeping year by a series of field workshops at a teaching apiary maintained by the Association.

The cost of each course is \$55 for an individual, or \$75 for a couple (one packet of materials), with lunch and refreshments. The registration packets include instructional materials, beekeeping periodicals, and equipment catalogs.

Registration is available at www.easternmobeekers.com/workshop, or by completing and mailing the downloadable registration form.

Space is limited, and will be filled on a first-come-first-served basis.

Registration closes February 15th.

More information is available at www.easternmobeekers.com, or by calling 314-894-8737.

The Eastern Missouri Beekeepers Association has been supporting beekeeping in the St. Louis metro area since 1939.

MSBA Web Page -- What's New? by Scott Moser

If you haven't checked out the MSBA website lately, you really should take the time to do so. There have been a lot of new features added, and more are on the way. One of the new things that have been added is an interactive map that lists various things pertaining to the MSBA. One of the things you will find on the map is the location of each of the current local associations. In addition, it is possible to show individual members on the map as well. If you would like your name to appear on the map, just drop me a note or an email, and I will update the map as soon as possible. This would be a great way for others to find you, and they can even get turn by turn directions to your door. In addition, it would also be possible to list products you sell, or services that you offer. What a great way to get your information out to others!

Another new feature that you will find there is our new MSBA discussion forum. The forum provides individuals with an opportunity to ask questions, provide information, list services, buy and sell, and learn more about the MSBA. The forum service is free, and open to the public. Reading the postings is open to anyone, but to post a question, or respond to a post, you must register. Registration is quick and easy to do, and only takes a couple of moments. After you register, stop by the "Introduce Yourself" forum and tell us a bit about you and your operation. Also, take a few moments and look over the "Rules of the Road" forum as well. What a great way for us to learn and share information with one another!

Coming soon to the website will be a page of downloadable information that you might find interesting and handy to have. All files posted there will be in PDF format, so be sure to download Adobe

Acrobat Reader, so you can take advantage of that. That page should be up and running this Spring.

Finally, at the bottom of the Home page, you will find a sponsored hotlink to Walter Kelley Beekeeping Supply. Beginning this year, it will be possible to post a dedicated link to your business website for a nominal fee. Clubs and non-profit informational sites will still be listed on the "Links" page for free. For information about having a hotlink to your website, email me, and I will give you the details.

There is a lot of good information there on our website. It is a wonderful way to get important information out to the membership and others. If you would like to have your name on the map, or would be interested in a business hotlink, you can email me at: smoser1963@hotmail.com, or from the "Officers" page of the site.



Fully assembled furniture grade pine hives. Built in High Ridge, MO. Each kit contains reversible bottom board, 2 hive bodies, inner cover and galvanized top cover for \$70.00. Other accessories also available. Pick-up only. Save on shipping. To order or for more info, email: beeblessed@sbcglobal.net or call Debbie 636-274-5009

**10% off all orders paid in full
before March 15th.**

Kansas' Honey Producers Association & Missouri State Beekeepers

Spring 2009 Meeting Registration Form

For additional forms go to www.nekba.org or www.mostatebeekeepers.org or call 913-856-8356

NAME _____

ADDRESS _____

CITY _____ STATE _____ ZIP+4 _____

PHONE _____ E-MAIL _____



Pre-registration Fees: Must be received by February 23rd, 2009

Member -- 2-day, per person \$25.00 X _____ = _____

Member Family -- 2-day (i.e. husband & wife, father & son etc.) \$35.00 X _____ = _____

Non-member -- 2-day, per person \$35.00 X _____ = _____

Registrations made after February 23rd:

Member -- 2-day, per person \$35.00 X _____ = _____

Member Family -- 2-day (i.e. husband & wife, father & son etc.) \$45.00 X _____ = _____

Non-member -- 2-day, per person \$45.00 X _____ = _____

Friday Night Banquet & Entertainment: Honey-orange chicken, rice, salad, vegetable, dessert

Adult - \$27.00/person (\$27.00 x _____) = _____

Child - \$12.00/person ages 4 and older (\$12.00 x _____) = _____

This is Lent if you prefer fish tell us how many _____

Friday, Deli Plate Lunch

Adult - \$20.00/person (\$20.00 x _____) = _____

Child - \$10.00/person ages 4 and older (\$10.00 x _____) = _____

This is Lent if you prefer fish tell us how many _____

Saturday, Deli Plate Lunch

Adult - \$20.00/person (\$20.00 x _____) = _____

Child - \$10.00/person ages 4 and older (\$10.00 x _____) = _____

Membership for Kansas' Honey Producers Association:

☐ Renewal ☐ New \$15.00 _____

Youth Membership '09 KHP (18 years of age or under)

☐ Renewal ☐ New \$7.50 _____

Membership 2009 Missouri State Beekeepers Assn. Individual: ☐ Renewal ☐ New \$15.00 _____

Membership 2009 Missouri State Beekeepers Assn. Family: ☐ Renewal ☐ New \$20.00 _____

Donation to Missouri Queen Fund \$ _____

Donation to Kansas Honey Producers Youth Scholarship Fund \$ _____

Total \$ _____

Please make checks payable to: Kansas' Honey Producers Assn or KHPA. Send to Robert Burns, 7601 w 54TH Terr. Overland Park, KS 66202 913-831-6096 email rburns@kc.rr.com (Registration will not be accepted by email.) *If you pre-register and then cannot attend, your registration fee will be considered a donation and no refunds will be made. If you pay for meals and we are able to sell them you will be refunded for those.*



KHPA/MSBA Spring 2009 Meeting Program

Thursday night, March 5th:

Board meeting for the Missouri State Beekeepers, 8:00 p.m., Sunflower Room

Board meeting for the Kansas Honey Producers, 8:30 p.m., Conference Room 922

Friday, March 6th

- 7:30-8:30 Registration, coffee & tea
- 8:30-8:45 Welcome & announcements
- 8:45-9:30 Clarence Collison Swarm Management - Are you Winning the Battle?
- 9:30-10:15 Nancy Gentry How to Get a Standard of Identity for Honey for Your State
- 10:15-10:45 Break
- 10:45-11:30 Deb Smith NGO (Non Governmental Agency) Bees for Development
- 11:30-12:15 Rudolf Jander Honeybees Smartly Decide When and Where to Forage
- 12:15-1:15 Lunch on your own or Deli Luncheon paid extra with registration
- 1:15-2:00 Danny Najera The Honeybee Waggle Dances: History & Cognition
- 2:05-2:45 Ron Fessenden The Honey Revolution
- 2:45-3:15 **Break** — visit vendors
- 3:15-4:00 Clarence Collison Factors Affecting Colony Buildup in the Spring
- 4:05-4:50 Jerry Brown State of the Industry
- 6:30 Banquet & Entertainment

Saturday, March 7th

- 7:45-8:15 Registration, coffee, set up for silent auction in Quail 1
- 8:15-8:25 Welcome & announcements
- 8:25-9:10 Clarence Collison Colony Collapse Disorder (CCD) - What do We Know?
- 9:15-10:00 Main Ballroom: **Installing a Package of Bees**, Steve Tipton
- Quail 2: **Plants for Honeybees**, Vera Gelder
- Quail 3: **Making Mead**, Bob Finck
- Quail 4:
- Sunflower:
- 10:00-10:25 **Break**
- 10:25-11:10 Main Ballroom: **Removing Swarms from Buildings**, Mike Allen & Glenn Davis
- Quail 2: **Walk at Walk About Acres—Exploring Agritourism**, Art & Vera Gelder
- Quail 3: **Bee Photography -- Shooting and Optimizing for Web and Print**, Eugene Makovec
- Quail 4: **Producing Comb Honey**
- Sunflower:
- 11:15-12:00 Main Ballroom: **Honeybee Biology**, Gary Ross
- Quail 2: **Communication Among Beekeeping Groups**, Jerry Brown
- Quail 3: **Food Safety to Include Audits and Licensing**, Jacquie Rowan
- Quail 4: **Soapmaking 101 — Getting Started**, Becky Tipton
- Sunflower:
- 12:00-1:00 Lunch on your own or Deli Luncheon (paid extra with registration)
- Vendors will be packing up at this time
- 1:00-1:45 Main Ballroom: **Installing a Package of Bees**, Steve Tipton



KHPA/MSBA Spring 2009 Meeting Program (continued)

- Quail 2: **The Energy Auditor/Beekeeper and Infrared Views** — Energy conservation measures one can do or consider in the Honey House (or your own home): Hidden heat losses, looking at some hives during the winter using an I.R. camera to evaluate winter survival, Greg Swob
- Quail 3: **Youth Scholarship Program — Are You Interested in Starting a Program in Your Club?** Presentation from several of the 2008 Kansas Youth Scholarship recipients, Becky Tipton moderates
- Quail 4: **Honeybee Diseases Q&A**, Scott Moser
- Sunflower:
- 1:50-2:35 Main Ballroom: **Requeening & Making Splits**, Kristi Sanderson
- Quail 2: **Making Creamed Honey**, Cecil Sweeney
- Quail 3: Nancy Gentry, **Topic to be announced**
- Quail 4:
- Sunflower:
- 2:35-2:55 **Break**, End of Silent Auction
- 2:55-3:40 Main Ballroom:
- Quail 2: Ron Fessenden, **The Honey Revolution — Focusing on Diabetes, Sleep Disorders and Antibiotic Use**
- Quail 3: **Making Honey Beers**
- Quail 4: **Making Balms and Lotions**, Sharon Gibbons & MO Honey Queen Tara Fisher
- Sunflower: **Preparing Honey for Competition from a Judge's Viewpoint**, Gary Ross
- 3:45-4:30 Main Ballroom: Clarence Collison, **What if?**
- Quail 2: **Electronic Media**, Scott Moser
- Quail 3:
- Quail 4: **Advanced Beeswax**, Sharon Rowan
- Sunflower:
- 4:35- Door Prizes & Raffle Drawings, Main Ball room
- Program and Speakers Subject to Change**

Spring Meeting program loaded with apicultural intellect

continued from page 1

Dr. Ron Fessenden, MD, MPH, is a retired medical doctor. Dr. Fessenden received his MD from the University of Kansas School of Medicine in 1970, and his Masters in Public Health from the University of Hawaii in 1982. For the past two years he has been researching and writing about the health benefits of honey. He is co-author of *The Honey Revolution: Restoring the Health of Future Generations*.

Dr. Fessenden is Co-Chair of the Committee for the Promotion of Honey and Health, an international organization committed to communicating the message of honey and health, encouraging research on honey, and establishing honey quality standards worldwide.

Dr. Rudolf Jander is the last doctoral student of Karl Von Frisch,

of waggle dance fame. His research focuses on experimental analysis of behavioral mechanisms and reconstruction of behavioral macro-evolution. This work emphasizes social insects, and includes a variety of arthropod and non-arthropod taxa.

Danny Najera is a current PhD candidate in entomology, and holds a BS in biology from the University of Kansas. His research interests include honeybee cognition and comparative cognition.

Dr. Deborah Smith received her PhD from Cornell University, and is currently at KU in the Department of Ecology and Evolutionary Biology. She is one of the foremost authorities on Bees of the World.

Nancy Gentry is president of the Northeast Florida Honey Bee Association and director of public relations for the Florida State Beekeepers Association.

**Stock Up
Now for the
New Season!**

QUALITY WOODENWARE

—A DADANT MANUFACTURING SPECIALTY—

**Ask about
our assembled
woodenware!**

Hive Bodies And Honey Supers

*Dadant Super Construction . . .
Small Details Make A Big Difference*
Ponderosa Pine Wood Products

Our woodenware is manufactured from hand selected ponderosa pine. Each board has been carefully moisture-metered to assure its proper moisture content before it is precision milled into the finished product. All our supers have "pre-drilled" holes for nails to prevent splitting during assembly.

3 Basic Grades

- Select:** A grade that is truly "selected" which allows only very small tight knots and no deviations in the dovetail, rabbets, or hand holds.
- Commercial:** The most widely used by commercial beekeepers. Tight knots are allowed where they occur except in the Dovetail and Rabbet.
- Economy:** The same precise fit as the other two grades but is a lower wood quality. Does not pass quality standards for "select" or "commercial" but is a good serviceable box. Layer knots and knots with crack or splits are allowed.

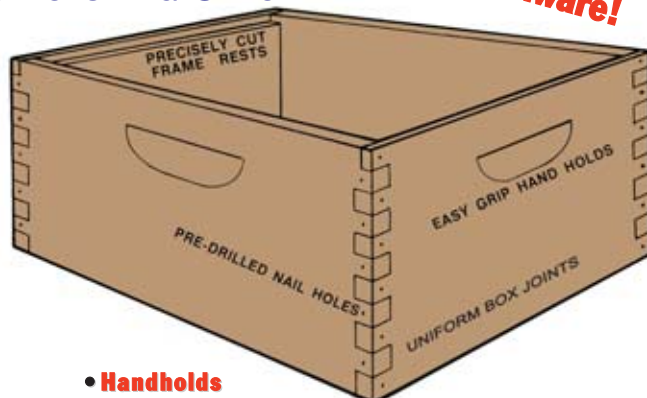

- **Handholds** tapered cut for easy gripping
- **Moisture Metering** before cutting to prevent warping
- **Uniform Dovetails** to prevent cracking
- **Predrilled Nail Holes** to prevent splitting
- **Box Joint Construction** for superior strength
- **Ponderosa Pine** from the Northwest. The best wood for the job.
- **Uniform Frame Rests** provides the proper "Bee Space"

Dadant Quality Frames

Dadant Frame Construction

—2 Frame Styles—

- **18% more wood in end bars** (Full $\frac{3}{8}$ " thickness)
- **Grooved bottom bar stronger and easier to use**

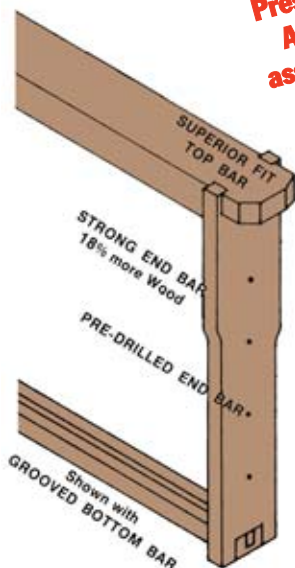

**Pressed for time?
Ask about our
assembled frames
with beeswax-
coated plasticell
foundation.**

Wedge Top Bar



- 1) Wood wedge is removed from frame.
- 2) Foundation is placed in frame.
- 3) Wood wedge is held firmly against foundation and nailed or stapled in place.

NOTE: Unless otherwise specified, frames with grooved bottom bars will be shipped. **SOLID AND SLOTTED BOTTOM BARS ARE AVAILABLE IN 100 OR MORE QUANTITY.** Please specify bottom bar desired.

Grooved Top Bar

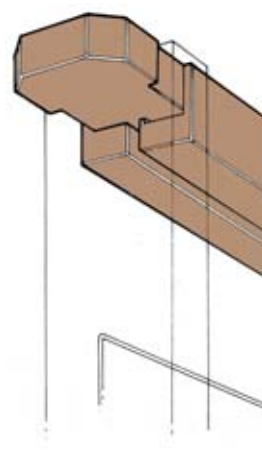

Foundation is placed in bottom-bar groove and top-bar groove. This frame works best with a rigid foundation such as Duragilt or Plasticell.

Dadant & Sons, Inc. 51 S. 2nd St., Hamilton, IL 62341

1-888-922-1293 Fax 1-217-847-3660 www.dadant.com

or your nearest Dadant branch location



Local Club Information

Beekeepers Association of the Ozarks

4th Tuesday of each month, 7:00 p.m.
The Library Center, 4653 S. Campbell, Springfield
www.ozarksbeekeepers.org

Boone Regional Beekeepers Association

3rd Sunday of odd months, 1:00 p.m., Columbia Insurance Group, 2102 Whitegate Dr. (back door), Columbia
Contact Art Gelder 573-474-8837
<http://beekeeper.missouri.org>

Busy Bee Club

4th Tuesday of each month, 7:00 p.m., Cedar County Health Center, Owens Mill Road, Stockton
Neal Lee 417-276-3090 Neil Brunner 314-276-4252
grnthumb@alltel.net

Eastern Missouri Beekeepers Association

2nd Wednesday of each month, 7:00 p.m., Powder Valley Nature Center 11715 Craigwold Rd., Kirkwood
Bob Sears, President 314-479-9517
www.easternmobeekers.com

Jackson Area Beekeepers

4th Tuesday of each month, 7:00 p.m.
First Pres. of Jackson, 206 E. Washington
Contact Grant Gillard 573-243-6568
gillard5@charter.net

Jefferson County Beekeepers Association

2nd Tuesday of each month, 7:30 p.m., Hwy B & 21
Jefferson County Extension Center, Hillsboro
Contact Scott Moser 636-285-7295

Joplin Area Beekeepers Association

Last Tue. of each month, 7 pm, SM Bank Community Building (7th and Duquesne Rd), Joplin
Contact Gene Foley 417-624-6831

Mid Missouri Beekeepers

3rd Sunday of each month, 2 pm, St. James Tourist Ctr.
Contact Don Moore 573-265-8706

Midwestern Beekeepers Association

Nov-March, 3rd Sunday of each month, 2:30 p.m.
April-Oct, 3rd Thursday of each month, 7:00 p.m.
Bass Pro Shop, Independence, Conservation Room
Cecil Sweeney, President 913-856-8356

Mississippi Valley Beekeepers Association

Last Tuesday of Month in Quincy, IL
Contact Debi Bridgman 573-439-5228

Missouri Valley Beekeepers Association

3rd Monday of each month, 7:00 p.m.
Scenic Regional Library, Union
Contact Rodney Angell 573-764-2922
bee143@fidnet.com

Parkland Beekeepers

3rd Tuesday of each month, 108 Harrison, Farmington
Contact Gene Wood 573-431-1436

Pomme de Terre Beekeepers

2nd Thursday of each month, 7 pm
Missouri Extension Office, Hermitage
Contact Bessi Shryer 417-745-2527

South Central Missouri Beekeepers Association

1st Friday of month, Howell Electric Coop, West Plains
Steve Teeple, President 417-261-2210

Southern MO Beekeepers of Monett ("MOBees")

3rd Tuesday of each month, 7:00 p.m.
Monett High School VO-AG Building
Robert Sperandio, President 417-235-6959

Southwest Beekeepers Association

1st Tuesday of month, Neosho High School FFA Building
Contact Herb Spencer 417-472-7743

Four-frame nucs for sale

Young 2009 queens. Ready early to mid May. No frame swap.
\$80.00 each, you pick up (Cedar Hill area).
Contact Scott Moser 636-285-7295.

Five-frame nucs for sale

Ready early Spring. \$85 in cardboard box. Will deliver from central Florida to St. Louis or Columbia (for \$5 if I get a truckload.)
20% deposit John Sauls 407-431-3714 or hahunltd@att.net



6800 North Kircher Road
Columbia MO. 65202-7652

573-474-8837

fax 573-474-5830

walkaboutacres@agristar.net

www.walk-aboutacres.net

**Your local dealer for
beekeeping supplies**

**We generally have all of the basic
supplies in stock.**

***Make your visit a family outing! We
have a "walk-about" farm,
greenhouses and honey ice cream.***

**MSBA Membership Application**

Name _____
Spouse's Name _____
Address _____
City/State/Zip _____
Phone Number _____ Email* _____

☐

*Check here to receive
your newsletter via email.
This saves us roughly
\$10.00 per year in print-
ing and mailing costs.

NOTE: If you belong to a local association, please pay your state dues through your local club.

State Association Dues (Check only one box)

Adult Membership \$15.00 ☐

Family Membership \$20.00 ☐

Student Membership \$5.00 ☐

Amount Enclosed \$ _____

Make check payable to: Missouri State Beekeepers Association

Mail to: P.O. Box 448 Oak Grove, MO 64075

Magazine Discounts: Discounts are available for MSBA members to two beekeeping magazines. You may use their order forms and mail them yourself to the publishers as shown below:

**AMERICAN
BEE JOURNAL**

**ASSOCIATION
MEMBER SUBSCRIPTION**

SAVE 25%

Association _____ Secretary's Name _____
Subscriber's Name _____ Address _____
Address _____ City _____
City _____ State, Zip _____
State, Zip _____ Comments _____

☐ NEW ☐ RENEWAL U.S. ☐ 1 Yr. - \$19.10 ☐ 2 Yr. - \$36.15 ☐ 3 Yr. - \$50.95

(PRICES GOOD THROUGH DEC. 31, 2009)

Return white copy to: American Bee Journal, 51 S. 2nd St., Hamilton, IL 62341

Retain yellow copy for your records.



ASSOCIATION MEMBER SUBSCRIPTION
Bee Culture Magazine

Please Print Clearly

Association _____ Secretary's Name _____
Subscriber's Name _____ Address _____
Address _____ City _____
City _____ State, Zip _____
State, Zip _____ Comments _____
Phone # _____

For Office Use Only
Acct. # _____

☐ NEW ☐ RENEWAL ☐ 1 Yr. - \$21.00 ☐ 2 Yr. - \$38.00

Canada - add \$15.00 per year
All other foreign add \$20/year

Return white copy to: Bee Culture, Subscription Dept., P.O. Box 706, Medina, OH 44258

*Please discard any other forms. Use only this form. * Prices subject to change without notice.



Honey Queen Report

by Tara Fisher

Hello Everyone!

Happy New Year! I hope all of you had a wonderful holiday! For Christmas this year my mom and I took on the task of making lotion bars and lip balms in various flavors! Needless to say, they were fun and very easy to make!

My friends and family sure enjoyed receiving them as gifts!! I encourage everyone who has wax sitting around to give it a try!!



In December, I attended the Midwestern Beekeepers Christmas Dinner. They had a wonderful pot luck dinner with almost five tables of food!! After a great meal, Roger and Sue Nichols gave a very interesting presentation on their trip to Australia last year when they attended the Apimondia. They had all kinds of souvenirs they shared and a wonderful slide show of pictures!

I also finished another semester of school! While I was on my break (which was 5 weeks long!!) I worked on scrapbooking the events that I have attended as the 2009 Missouri Honey Queen! I feel like I am running out of pictures!! With that being said, I would love to add more pictures to my collection! As the 2009 Missouri Honey Queen, I am here to promote honey and beekeeping! If you have any fairs, festivals, meetings, or activities that you would like for me to attend, please contact Joyce Justice, Queen Chairperson. Her contact information appears in the column at right.

Again, Happy New Year and I hope you all have a very healthy and happy 2009!!

Tara

When you start planning your markets and special events remember to make arrangements to have our Honey Queen attend. Please contact me as early as possible so she can work the timing into her schedule.

Joyce Justice
Queen Chairperson

DRAPER'S SUPER BEE

Specializing in:

**Bee Pollen
Beekeeping Supplies
Containers
Observation Hives**

Call for a free pollen sample & supply catalog
(402) 274-3725

Directory of Officers

President: Scott Moser 636-285-7295
6600 Davis Lane, Cedar Hill, MO 63016
president@mostatebeekeepers.org

Vice President: Grant Gillard 573 243-6568
3721 North High Street, Jackson, MO 63755
vicepresident@mostatebeekeepers.org

Secretary: Ken Sona 314-303-4646
19 McClay Crossing, St. Peters, MO 63376
secretary@mostatebeekeepers.org

Treasurer: Ron Vivian 816-690-7516
443 Fricke Road, Bates City, MO 64011-8280
treasurer@mostatebeekeepers.org

Past-President: Ken Norman 417-669-4452
3634 Shiloh Church Road, Marionville, MO 65705
pastpresident@mostatebeekeepers.org

Western Area Director: Glenn Davis 816-690-8007
4618 Highway Z, Bates City, MO 64011
westdir@mostatebeekeepers.org

Southern Area Director: Marlin Trout 417-830-7749
20445 Lawrence 2070, Ash Grove, MO 65604
southwdir@mostatebeekeepers.org

Eastern Area Director: Steve Harris 636-946-5520
1224 Sherbrooke Road, St. Charles, MO 63303
eastdir@mostatebeekeepers.org

Southeastern Area Director: Ray Batton 573-686-4888
3032 N. 14th St., Poplar Bluff, MO 63901
southedir@mostatebeekeepers.org

Program Chairperson: Sharon Gibbons 636-394-5395
314 Quinnmoor Dr., Ballwin, MO 63011
sgibbs314@earthlink.net

Newsletter Editor: Eugene Makovec 314-965-4631
643 Pearl Ave., Kirkwood, MO 63122
editor@mostatebeekeepers.org

Auxiliary Treasurer: Dolores Vivian 816-690-7516
443 Fricke Road, Bates City, MO 64011-8280
H1ybee@aol.com

Queen Chairperson: Joyce Justice 816-358-3893
P.O. Box 16566, Raytown, MO 64133-0566
queenchair@mostatebeekeepers.org

State Fair Chairman: Dean Sanders cell 816-456-4683
37804 Old Pink Hill Road, Oak Grove, MO 64075

Assist. Prof. Entomology/Extension Spec.:
Dr. Richard Houseman
1-87 Agricultural Building, University of Missouri-Columbia, Columbia, MO 65211

Missouri State Beekeepers Association

P.O. Box 448 Oak Grove, MO 64075

www.mostatebeekeepers.org



A little paint and some nails ...

... and it's good as new, right? Okay, maybe a lot of paint, a big bucket of nails and a great deal of new wood. In all probability, this old barn has been abandoned because it's no longer needed, and the landowner has neither the time nor the money to tear it down and haul it away.

Do you have a beeyard that looks like it's been abandoned? Are your bees barely making it because there are too many "entrances" to protect from intruders or the weather? If you're a city beekeeper, do your neighbors really need another reason to complain about your peculiar form of agriculture?

Now is the perfect time to upgrade your equipment. Contact one of our advertisers and place your order before things get really busy. See inside for details on which vendors are attending the upcoming Spring Meeting, and you can arrange to pick up your order there, sans shipping charges.

-- photo by Eugene Makovec

\$ Are you current?
If you have not paid your
2009 dues, this will be your
last newsletter.

This newsletter is published six times per year, in even months. Submissions are due by the 15th of the month prior to publication.

The email edition is in color, and contains hyperlinks and bonus back-page material, while the print version is in black-and-white. If you are a member currently receiving the printed newsletter and you wish to upgrade, just send an email to editor@mostatebeekeepers.org with "email newsletter" in the subject line. I'll reply with confirmation, and add you to my list.

Advertising rates are as follows:

Business card size	\$15.00	Half page	\$50.00
Quarter page	\$35.00	Full page	\$100.00

Classified Ads: Advertise one to three beekeeping-related items in a one-line ad at no charge. This service is for non-commercial MSBA members only, and is limited to one ad per item per calendar year.

Honey Trading Post: This is a free service to members wishing to buy or sell honey on a wholesale basis. Just email or call the editor with contact information and whether you are buying or selling. Pricing is between the interested parties.